

Plotted: 6/3/2024 10:21 AM By: NCG
H:\MLS\12277\12277.00\DRAWINGS\ENG\12277P00.dwg

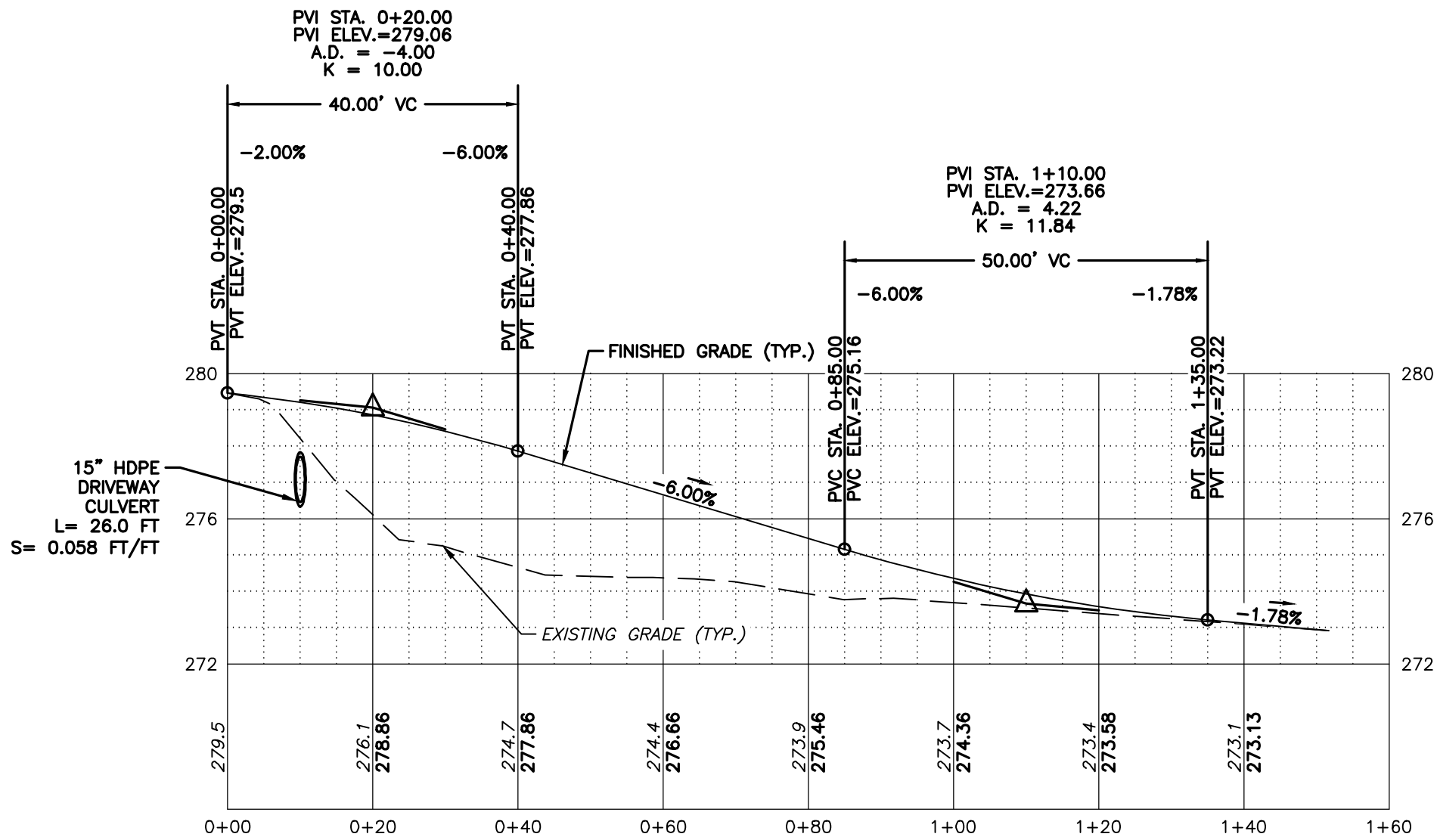

- DRIVEWAY NOTES.**
1. THE PURPOSE OF THIS PLAN IS TO DEMONSTRATE THAT AN AMHERST COMPLIANT DRIVEWAY CAN ACCESS THE REMAINDER OF LOT 6-30.
 2. DRIVEWAYS SHALL BE A MINIMUM OF TEN (10) FEET IN WIDTH.
 3. THE DRIVEWAY SHALL SLOPE AWAY FROM THE EDGE OF THE ROADWAY AT A SLOPE OF 1% FOR A DISTANCE OF TWENTY (20) FEET.
 4. THE SLOPE OF DRIVEWAYS SHALL NOT EXCEED EIGHT (8) PERCENT.
 5. ALL DRIVEWAYS SHALL INTERSECT THE TOWN'S ROADWAY AT A PERPENDICULAR ANGLE TO THE CENTERLINE OF EACH.

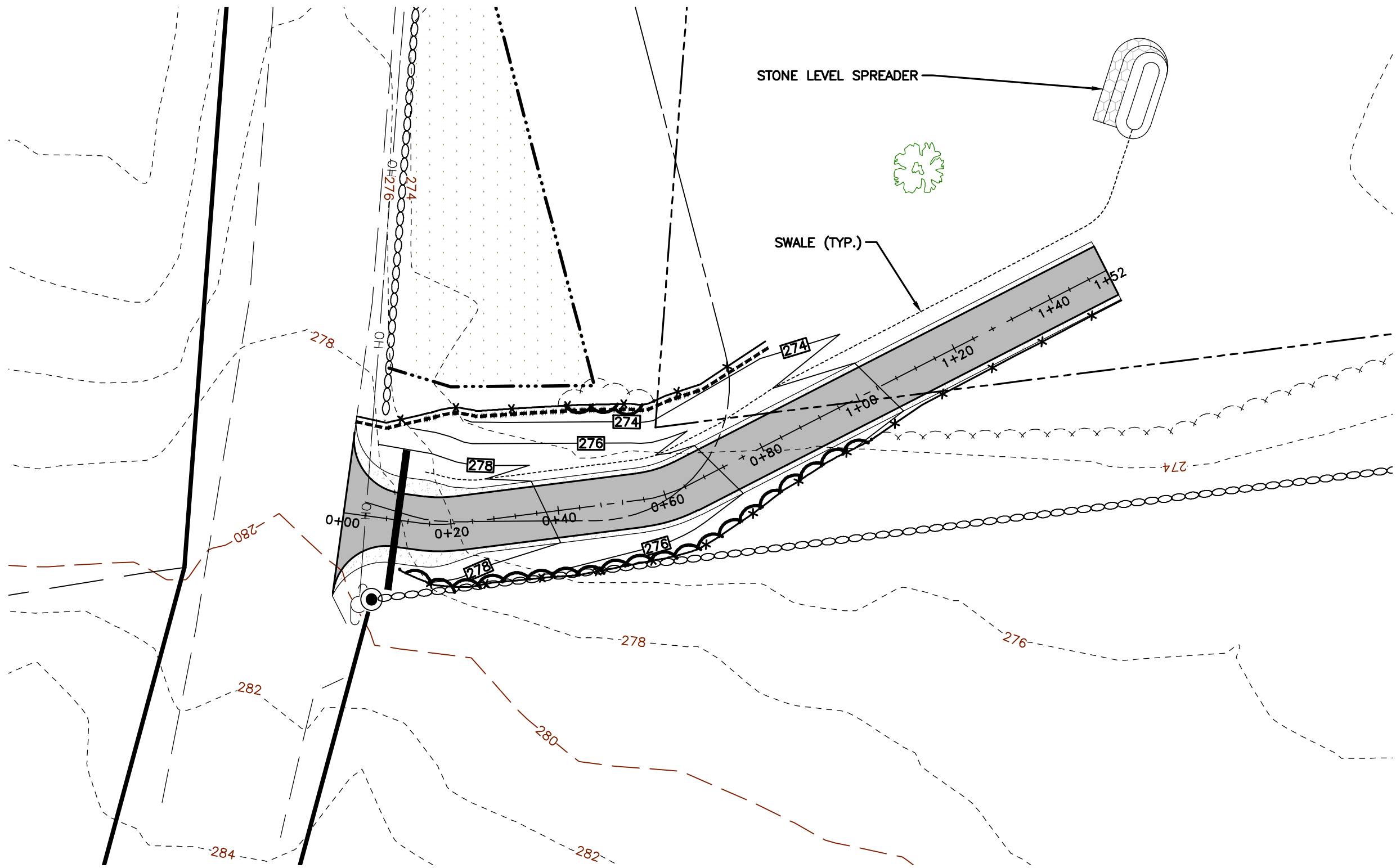
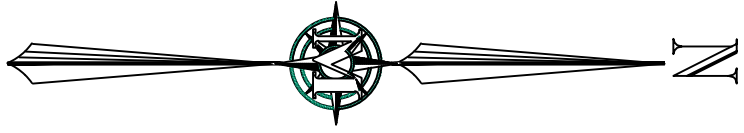
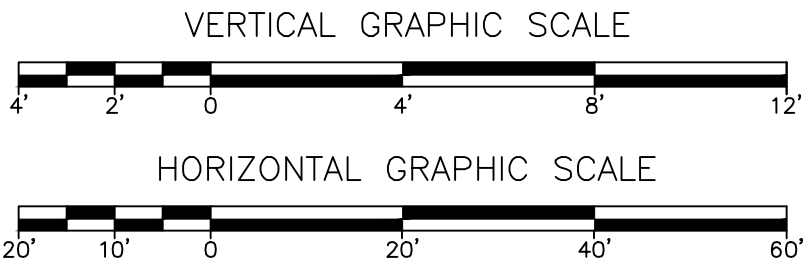
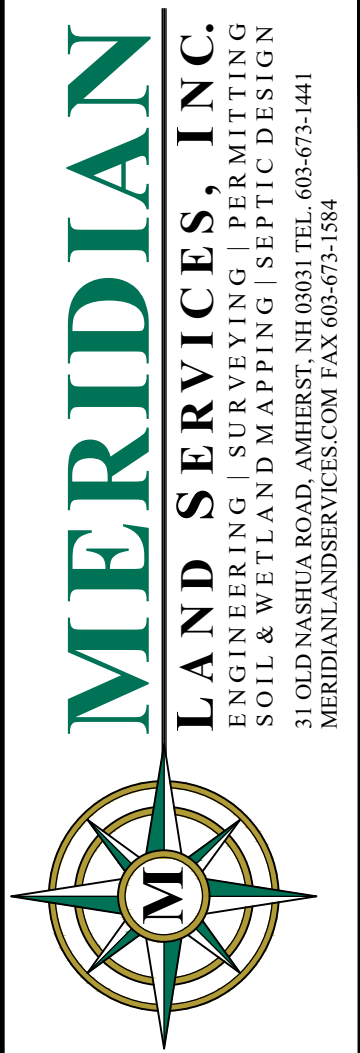

MERIDIAN
LAND SERVICES, INC.
ENGINEERING | SURVEYING | PERMITTING
SOIL & WETLAND MAPPING | SEPTIC DESIGN
3 OLD NASHUA ROAD, AMHERST, NH 03051 TEL: 603-673-1441
MERIDIANLANDSERVICES.COM FAX: 603-673-1584

REV.	DATE	DESCRIPTION	DR	CK
I	---	---	---	---
H	---	---	---	---
G	---	---	---	---
F	---	---	---	---
E	---	---	---	---
D	---	---	---	---
C	---	---	---	---
B	---	---	---	---
A	---	---	---	---

DRIVEWAY GRADING EXHIBIT

LISA KAVENEY TAX MAP 6 LOT 30 82 BABOOSIC LAKE ROAD AMHERST, NEW HAMPSHIRE	JUNE 3, 2024
P-1 SHEET	
FILE: 12277P00.dwg	
PROJECT: 12277.00	
SHEET NO. 1 OF 2	

FILL SECTION

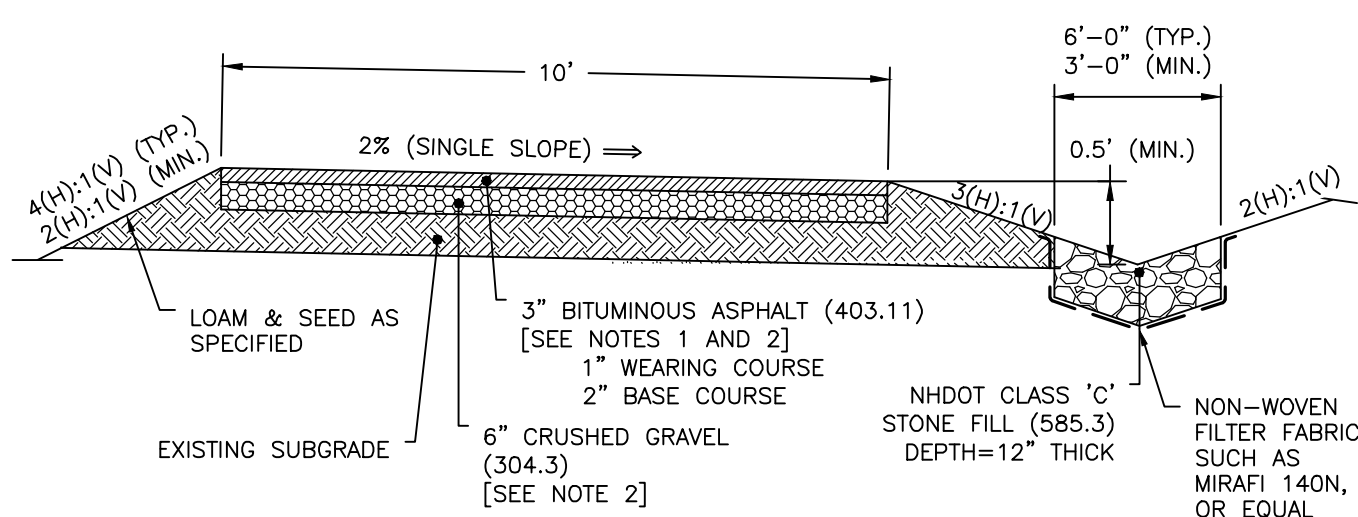

CUT SECTION

GENERAL CONSTRUCTION NOTES:

1. REMOVE ALL LOAM, CLAY, MUCK, STUMPS, AND OTHER IMPROPER ROAD FOUNDATION MATERIAL WITHIN 3' OF SUB-GRADE. REPLACE WITH COMPACTED GRANULAR FILL MATERIAL ACCEPTABLE TO THE ROAD INSPECTOR. COMPACTION TO BE AT LEAST 95% OF THE DRY WEIGHT AS DETERMINED BY MODIFIED PROCTOR TESTING (ASTM 1557).
2. ALL PAVEMENT, BASE MATERIALS AND WORKMANSHIP TO BE IN COMPLIANCE WITH N.H.D.O.T. "STANDARD SPECIFICATIONS FOR ROAD AND BRIDGE CONSTRUCTION" 2016 EDITION.
3. A 2.5' SHOULDER IS REQUIRED WHEREVER GUARDRAILS ARE TO BE LOCATED TO PROVIDE FOR GUARDRAIL CONSTRUCTION AND SUPPORT.
4. UNDERDRAIN SHALL BE REQUIRED IN CUT SECTIONS AS DETERMINED BY THE AMHERST ROAD INSPECTOR. THE PIPE SHALL DISCHARGE THROUGH A MORTARED RUBBLE AND MASONRY ENDWALL OR INTO A CATCH BASIN.
5. WHERE ROAD GRADE IS MORE THAN 5%, ROAD SWALE SHALL BE LINED WITH RIPRAP (2 LAYERS, 4" STONE, 6" WIDE WITH 6" GRAVEL BASE OR EROSION CONTROL FABRIC). WHERE ROAD GRADE IS LESS THAN 5%, EROSION CONTROL FABRIC SHALL BE INSTALLED EXTENDING 3' EACH SIDE FROM SWALE CENTERLINE.
6. ALL TRANSFORMER SLABS SHALL BE LOCATED AT THE RIGHT OF WAY LINE.

SINGLE SLOPED DRIVEWAY CROSS SECTION

SCALE: NONE

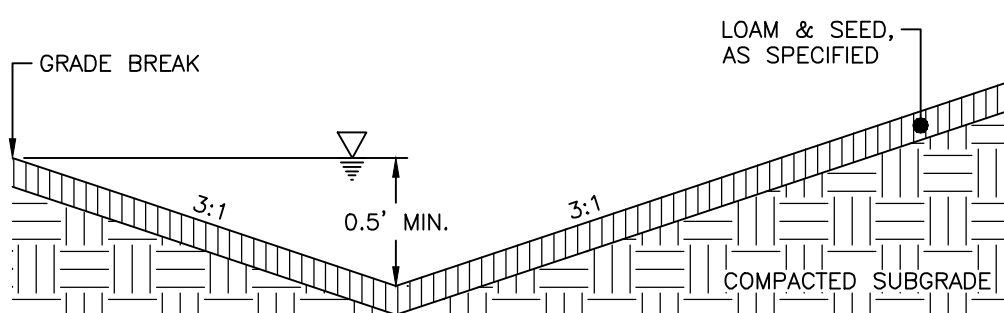
1
D-1

CONVEYANCE SWALE

SCALE: NONE

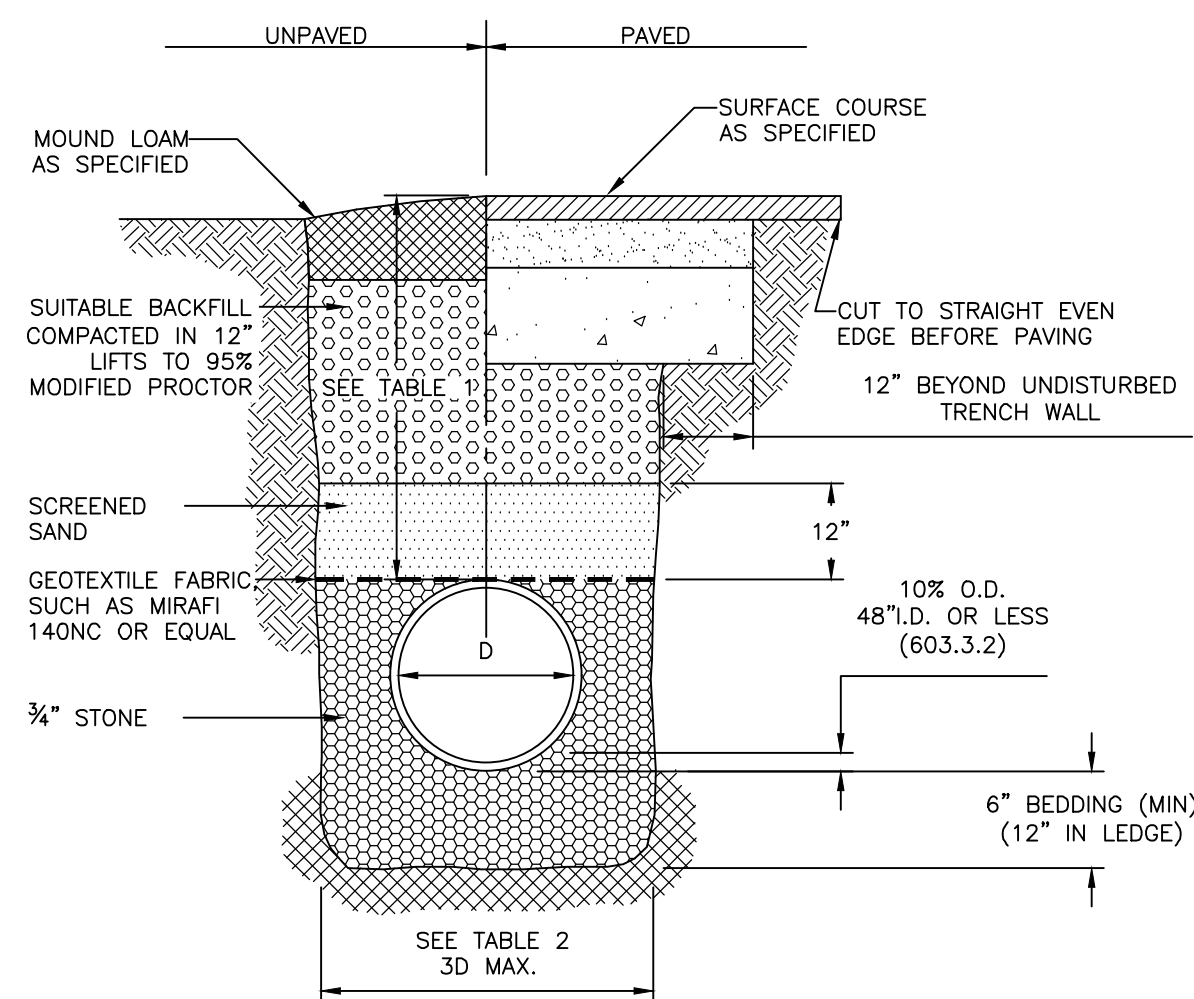
2
D-1

LOCATION	PIPE MATERIAL	MINIMUM COVER
PAVED ROADS	ALL	3 FT.
UNPAVED ROADS	ALL	3 FT.
DRIVEWAYS	ALL	1 FT.
UNPAVED AREAS	ALL	2 FT.

INSIDE DIAMETER	TOTAL WIDTH
12" TO 24"	I.D. + 24"
OVER 24"	2 x I.D.

TYPICAL DRAINAGE PIPE TRENCH

SCALE: NONE

3
D-1

LEVEL SPREADER CROSS-SECTION

SCALE: NONE

4
D-1

NOTES:

1. CONSTRUCT THE LEVEL SPREADER LIP ON A ZERO PERCENT GRADE TO ENSURE UNIFORM SPREADING OF RUNOFF.
2. THE RECEIVING AREA SHALL BE STABLE PRIOR TO CONSTRUCTION OF THE LEVEL SPREADER.
3. THE LEVEL LIP AREA SHALL BE PROTECTED BY PLACING A STONE BERM 1.5' H X 5' W ALONG THE ENTIRE LENGTH OF THE LIP.
4. THE FLOW FROM THE LEVEL SPREADER SHALL OUTLET ONTO STABILIZED AREAS. WATER SHOULD NOT RE-CONCENTRATE IMMEDIATELY BELOW THE SPREADER.
5. PERIODIC INSPECTION AND REQUIRED MAINTENANCE SHALL BE PERFORMED.

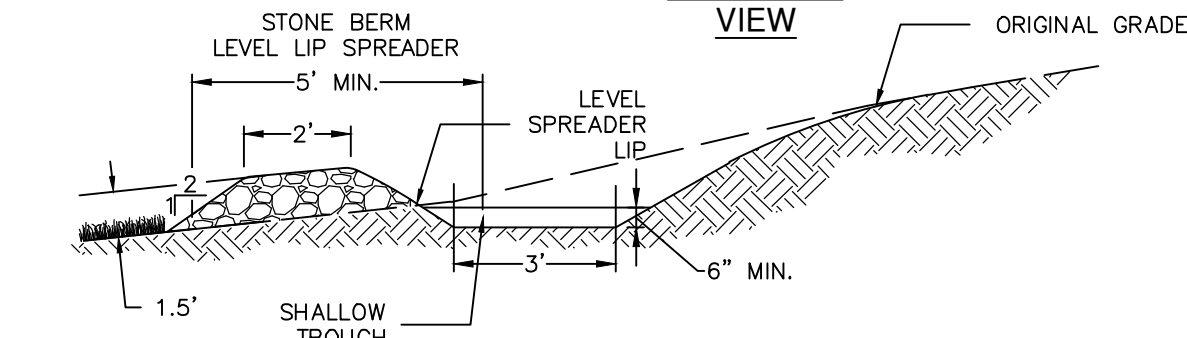

SIEVE/DESIGNATION	% PASSING/ BY WEIGHT
12 IN.	100
6 IN.	84-100
3 IN.	68-83
1 IN.	42-55
#4	8-12

ISOMETRIC VIEW

1. THE PROJECT DISTURBS MORE THAN ONE (1) ACRE OF LAND AND REQUIRES A CONSTRUCTION GENERAL PERMIT (CGP) FROM THE ENVIRONMENTAL PROTECTION AGENCY (EPA) AS PART OF THE NATIONAL POLLUTANT DISCHARGE ELIMINATION SYSTEM (NPDES) PHASE II STORMWATER ACT. PRIOR TO THE START OF CONSTRUCTION THE CONTRACTOR SHALL PREPARE A STORMWATER POLLUTION PREVENTION PLAN (SWPPP) AND FILE A NOTICE OF INTENT (NOI) WITH THE EPA. THE CONTRACTOR SHALL CONFIRM THAT THE OWNER HAS ALSO FILED AN NOI.
2. PRIOR TO STARTING ANY OTHER WORK ON THE SITE, THE CONTRACTOR SHALL NOTIFY APPROPRIATE AGENCIES AND SHALL INSTALL EROSION CONTROL MEASURES AS SHOWN ON THE PLANS.
3. THE CONTRACTOR SHALL INSPECT AND MAINTAIN EROSION CONTROLS, AND REMOVE SEDIMENT THEREFROM ON A WEEKLY BASIS AND WITHIN TWENTY FOUR HOURS AFTER EACH STORM EVENT (0.25" OR GREATER) AND DISPOSE OF SEDIMENTS IN AN UPLAND AREA SUCH THAT THEY DO NOT ENCUMBER OTHER DRAINAGE WAYS AND PROTECTED AREAS.
4. THE CONTRACTOR SHALL BE RESPONSIBLE TO CONTROL CONSTRUCTION SUCH THAT SEDIMENTATION SHALL NOT AFFECT REGULATORY PROTECTED AREAS (IE WETLANDS, STREAMS, ETC.) WHETHER SUCH SEDIMENTATION IS CAUSED BY WATER, WIND, OR DIRECT DEPOSITED.
5. THE CONTRACTOR SHALL PERFORM CONSTRUCTION SEQUENCING SUCH THAT EARTH MATERIALS ARE EXPOSED FOR A MINIMUM AMOUNT OF TIME BEFORE THEY ARE COVERED, SEEDED, OR OTHERWISE STABILIZED TO PREVENT EROSION.
6. UPON COMPLETION OF CONSTRUCTION AND ESTABLISHMENT OF PERMANENT GROUND COVER, THE CONTRACTOR SHALL REMOVE AND DISPOSE OF EROSION CONTROL MEASURES AND CLEAN DEBRIS AND SEDIMENT FROM THE DRAINAGE SYSTEM.
7. AREAS REMAINING UNSTABILIZED FOR A PERIOD OF MORE THAN 30 DAYS SHALL BE TEMPORARILY SEEDED AND MULCHED. HAY MULCH SHALL BE APPLIED AT A MINIMUM RATE OF 1-1/2 TONS/ACRE.
8. PERMANENT SEEDING SHALL OCCUR BETWEEN APRIL 1 AND JUNE 1 AND/OR BETWEEN AUGUST 15 AND OCTOBER 15. ALL SEEDING SHALL BE HAY MULCHED.
9. DUST SHALL BE CONTROLLED THROUGH THE USE OF WATER.
10. SOILS TO BE STOCKPILED FOR A PERIOD OF MORE THAN THIRTY DAYS SHALL BE TEMPORARILY SEEDED AND MULCHED. THE CONTRACTOR SHALL INSTALL SILT FENCE AND OR COMPOST SOCK ALONG THE DOWNHILL SIDE OF THE STOCKPILE.
11. THE CONTRACTOR SHALL PROVIDE TEMPORARY SEDIMENTATION BASINS AND TEMPORARY DIVERSION SWALES TO CONTROL SEDIMENTATION AND STORMWATER RUNOFF DURING THE CONSTRUCTION PERIOD, THAT MEET THE REQUIREMENTS OF THE NEW HAMPSHIRE DEPARTMENT OF ENVIRONMENTAL SERVICES (NHDES).
12. THE CONTRACTOR SHALL PROVIDE NECESSARY EROSION CONTROLS TO INSURE THAT SURFACE WATER RUNOFF FROM UNSTABILIZED AREAS DOES NOT CARRY SILT, SEDIMENT, AND OTHER DEBRIS OUTSIDE THE SITE WORK AREA.
13. AN AREA SHALL BE CONSIDERED STABILIZED IF ONE OF THE FOLLOWING HAS OCCURRED:
 - A. BASE COURSE GRAVELS HAVE BEEN INSTALLED IN AREAS TO BE PAVED AND COMPACTED TO A MINIMUM OF 90% OF THE DRY UNIT WEIGHT;
 - B. A MINIMUM OF 85% VEGETATIVE GROWTH HAS BEEN ESTABLISHED;
 - C. A MINIMUM OF 3-IN. OF NON EROSION MATERIAL, SUCH AS STONE OR RIPRAP HAS BEEN INSTALLED;
 - D. EROSION CONTROL BLANKETS HAVE BEEN PROPERLY INSTALLED;
 - E. THE AREA HAS BEEN PAVED WITH BITUMINOUS ASPHALT CONCRETE, PORTLAND CEMENT CONCRETE, OR SIMILAR COVERS.

15. AT NO TIME SHALL THE TOTAL DISTURBED AREA BE GREATER THAN FIVE (5) ACRES.
16. ALL DITCHES, SWALES, STORMWATER BASINS, OR OTHER DRAINAGE FEATURES SHALL BE FULLY STABILIZED PRIOR TO DIRECTING STORMWATER TO THEM.
17. ALL DRIVEWAYS, ROADWAYS, AND/OR PARKING AREAS SHALL BE STABILIZED WITHIN 72 HOURS OF ACHIEVING FINISH GRADE.
18. ALL CUT AND FILL SLOPES SHALL BE LOAMED AND SEEDED WITHIN 72 HOURS OF ACHIEVING FINISH GRADE.
19. EROSION CONTROL BLANKETS SHALL BE INSTALLED ON ALL SLOPES THAT ARE STEEPER THAN 3-FT HORIZONTAL TO 1-FT VERTICAL (3:1). EROSION CONTROL BLANKETS SHALL BE NORTH AMERICAN GREEN SC150BN OR APPROVED EQUAL.
20. THE CONTRACTOR SHALL APPLY FOR AND RECEIVE AN NHDES GROUNDWATER DISCHARGE PERMIT, PRIOR TO CONDUCTING ANY DEWATERING EFFORTS AND/OR PUMPING OF GROUNDWATER.
21. EXISTING VEGETATION IS TO REMAIN UNDISTURBED WHEREVER POSSIBLE.
22. ALL DISTURBED AREAS SHALL BE COVERED WITH A MINIMUM OF 6" OF LOAM. LOAM SHALL BE COVERED WITH THE APPROPRIATE SEED MIXTURE AS INDICATED BELOW. THE SEED MIXTURE SHALL BE APPLIED AT A RATE OF 2.5 POUNDS PER 1,000 SQ. FT.

AND SHALL BE MIXED AS FOLLOWS:

TYPICAL LAWN SEED	CREeping RED FESCUE	0.87 LBS.	SLOPE SEED	CREeping RED FESCUE	1.01 LBS.
KENTUCKY BLUEGRASS	0.71 LBS.	RYE GRASS	0.75 LBS.		
RYE GRASS	0.58 LBS.	RED TOP	0.18 LBS.		
RED TOP	0.14 LBS.	ALSIKE CLOVER	0.18 LBS.		
		BIRDSFOOT TREFOIL	0.18 LBS.		

23. APPLY LIMESTONE AND FERTILIZER ACCORDING TO SOIL TEST RECOMMENDATIONS. IF SOIL TESTING IS NOT FEASIBLE ON SMALL OR VARIABLE SITES, OR WHERE TIMING IS CRITICAL, FERTILIZER MAY BE APPLIED AT THE RATE OF 600 POUNDS PER ACRE OR 13.8 POUNDS PER 1,000 SQUARE FEET OF LOW PHOSPHATE FERTILIZER (N-P205-K2O) OR EQUIVALENT (LOW PHOSPHORUS FERTILIZER IS DEFINED BY THE COMPREHENSIVE SHORELAND PROTECTION ACT AS LESS THAN 2% PHOSPHORUS). APPLY LIMESTONE (EQUIVALENT TO 50 PERCENT CALCIUM PLUS MAGNESIUM OXIDE) AT A RATE OF 3 TONS PER ACRE (138 LB. PER 1,000 SQUARE FEET).
24. FERTILIZER SHOULD BE RESTRICTED TO A LOW PHOSPHATE, SLOW RELEASE NITROGEN FERTILIZER WHEN APPLIED TO AREAS BETWEEN 25 FEET AND 250 FEET FROM A SURFACE WATER BODY AS SPECIFIED BY THE COMPREHENSIVE SHORELAND PROTECTION ACT (SLOW RELEASE FERTILIZERS MUST BE AT LEAST 50% SLOW RELEASE NITROGEN COMPONENT). NO FERTILIZER EXCEPT LIMESTONE SHOULD BE APPLIED WITHIN 25 FEET OF THE SURFACE WATER. THESE LIMITATIONS ARE REQUIREMENTS.
25. PERMANENT OR TEMPORARY COVER MUST BE IN PLACE BEFORE THE GROWING SEASON ENDS. WHEN SEEDED AREAS ARE MULCHED, PLANTINGS MAY BE MADE FROM EARLY SPRING TO EARLY OCTOBER. WHEN SEEDED AREAS ARE NOT MULCHED, PLANTINGS SHOULD BE MADE FROM EARLY SPRING TO MAY 20 OR FROM AUGUST 10 TO SEPTEMBER 15. NO DISTURBED AREA SHALL BE LEFT EXPOSED DURING THE WINTER MONTHS.
26. WHEN PROJECT ACTIVITIES ARE WITHIN 50 FEET OF A WATER BODY OR WETLAND, DOUBLE ROW OF EROSION CONTROL IS REQUIRED.
27. ALL AREAS OF UNSTABILIZED SOIL SHALL BE:
 - A. TEMPORARILY STABILIZED AS SOON AS PRACTICABLE BUT IN ALL CASES WITHIN 45 DAYS OF INITIAL DISTURBANCE, UNLESS A SHORTER TIME IS SPECIFIED BY LOCAL AUTHORITIES, THE CONSTRUCTION SEQUENCE APPROVED AS PART OF THE ISSUED PERMIT, OR AN INDEPENDENT MONITOR; AND
 - B. PERMANENTLY STABILIZED AS SOON AS PRACTICABLE BUT IN ALL CASES WITHIN 3 DAYS OF FINAL GRADING.
28. A CERTIFIED PROFESSIONAL IN EROSION AND SEDIMENT CONTROL OR A PROFESSIONAL ENGINEER LICENSED IN THE STATE OF NEW HAMPSHIRE ("MONITOR") SHALL BE EMPLOYED TO INSPECT THE SITE FROM THE START OF ALTERATION OF TERRAIN ACTIVITIES UNTIL THE SITE IS IN FULL COMPLIANCE WITH THE ALTERATION OF TERRAIN PERMIT ("PERMIT").
 - DURING THIS PERIOD, THE MONITOR SHALL INSPECT THE SUBJECT SITE AT LEAST ONCE A WEEK, AND IF POSSIBLE, DURING ANY 1/2 INCH OR GREATER RAIN EVENT (I.E. 1/2 INCH OF PRECIPITATION OR MORE WITHIN A 24 HOUR PERIOD). IF UNABLE TO BE PRESENT DURING SUCH A STORM, THE MONITOR SHALL INSPECT THE SITE WITHIN 24 HOURS OF THIS EVENT.
 - THE MONITOR SHALL PROVIDE TECHNICAL ASSISTANCE AND RECOMMENDATIONS TO THE CONTRACTOR ON THE APPROPRIATE BEST MANAGEMENT PRACTICES FOR EROSION AND SEDIMENT CONTROLS REQUIRED TO MEET THE REQUIREMENTS OF RSA 485-A:17 AND ALL APPLICABLE DES PERMIT CONDITIONS.
 - WITHIN 24 HOURS OF EACH INSPECTION, THE MONITOR SHALL SUBMIT A REPORT TO DES VIA EMAIL (TO GLOIA.ANDREWS@DES.NH.GOV).
 - PRIOR TO BEGINNING CONSTRUCTION, THE CONTRACTOR'S NAME, ADDRESS, AND PHONE NUMBER SHALL BE SUBMITTED TO DES VIA EMAIL (SEE ABOVE).

EROSION CONTROL NOTES

SCALE: NONE

6
D-1

STONE CHECK DAM

SCALE: NONE

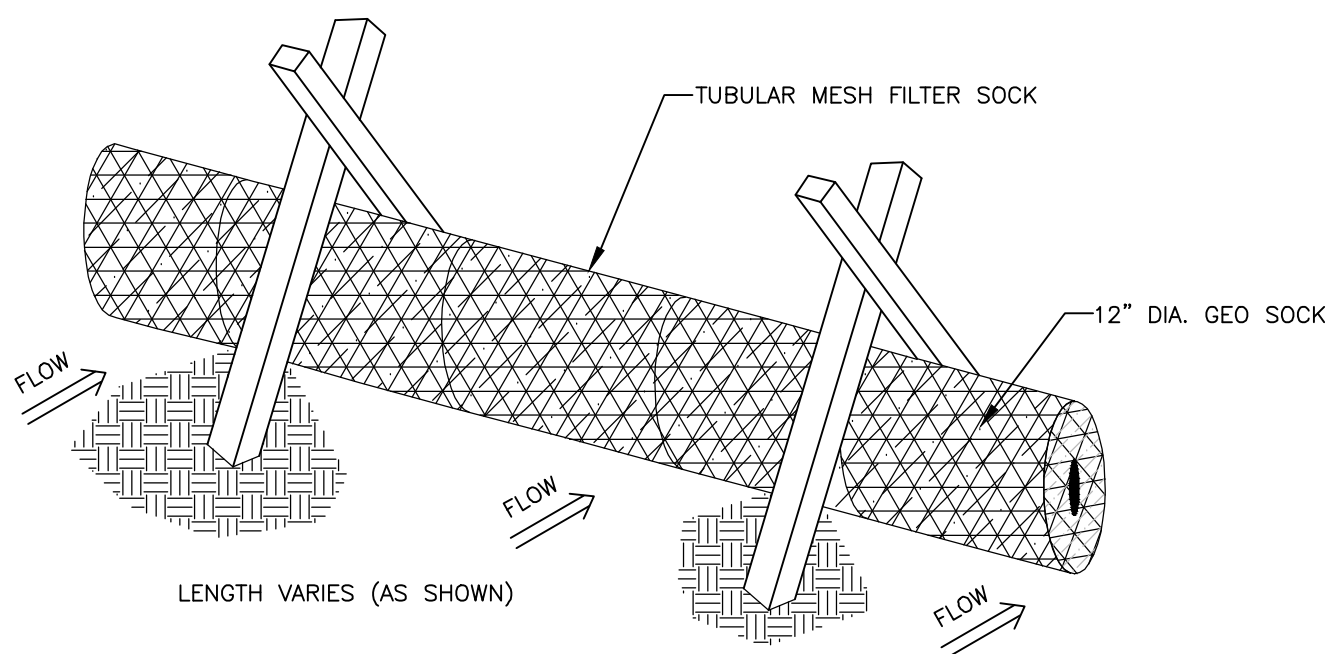
9
D-1

NOTES:

1. THE COMPOST SOCK SHALL BE A MESH TUBE FILLED WITH COMPOSTED MATERIAL.
2. MINIMAL CLEARING MAY BE REQUIRED TO INSTALL FILTER SOCKS.
3. INSTALL FILTER SOCKS PRIOR TO ANY CLEARING OR GRUBBING.

COMPOST SOCK

SCALE: NONE

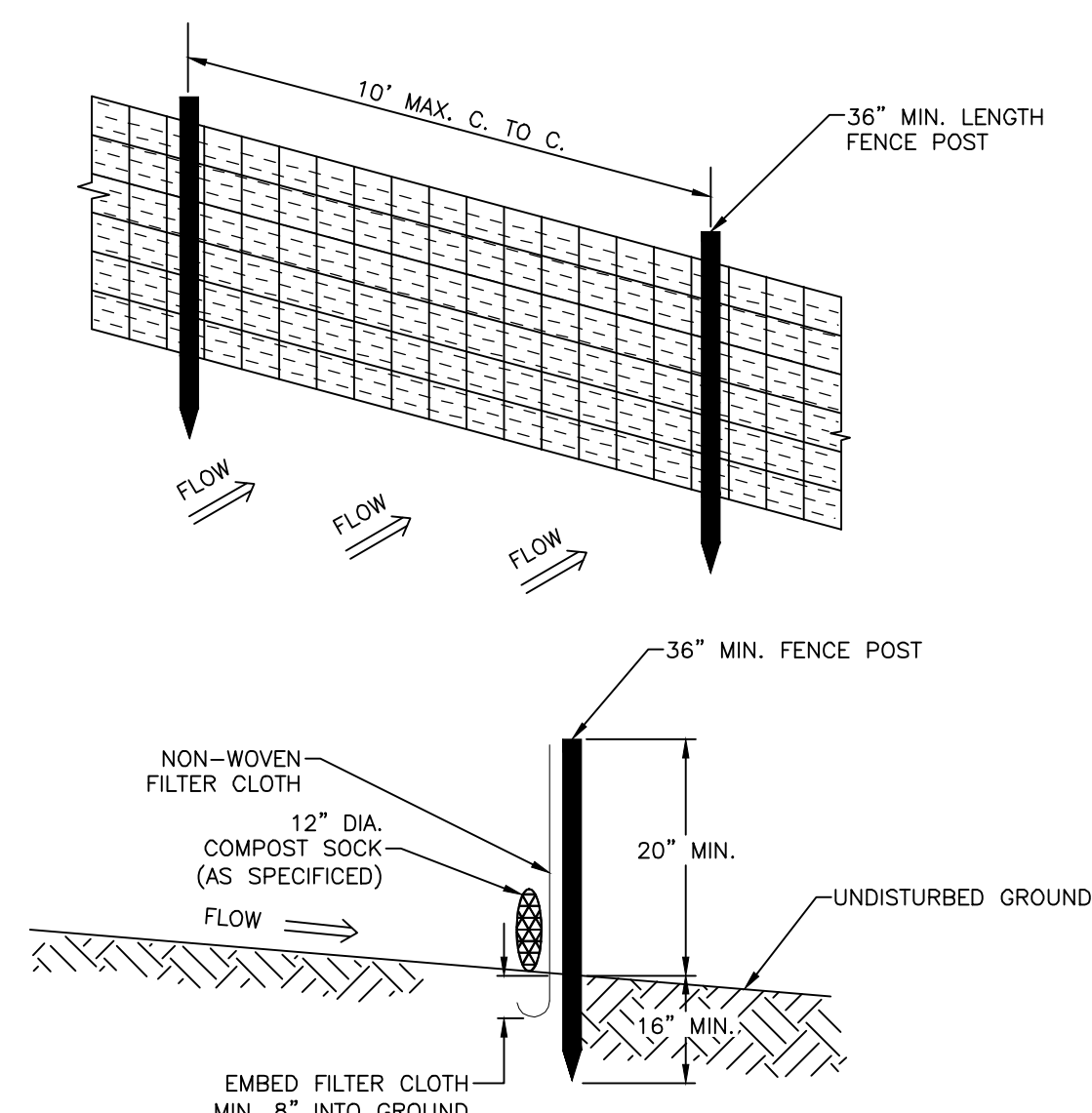
7
D-1

SILTATION FENCE

SCALE: NONE

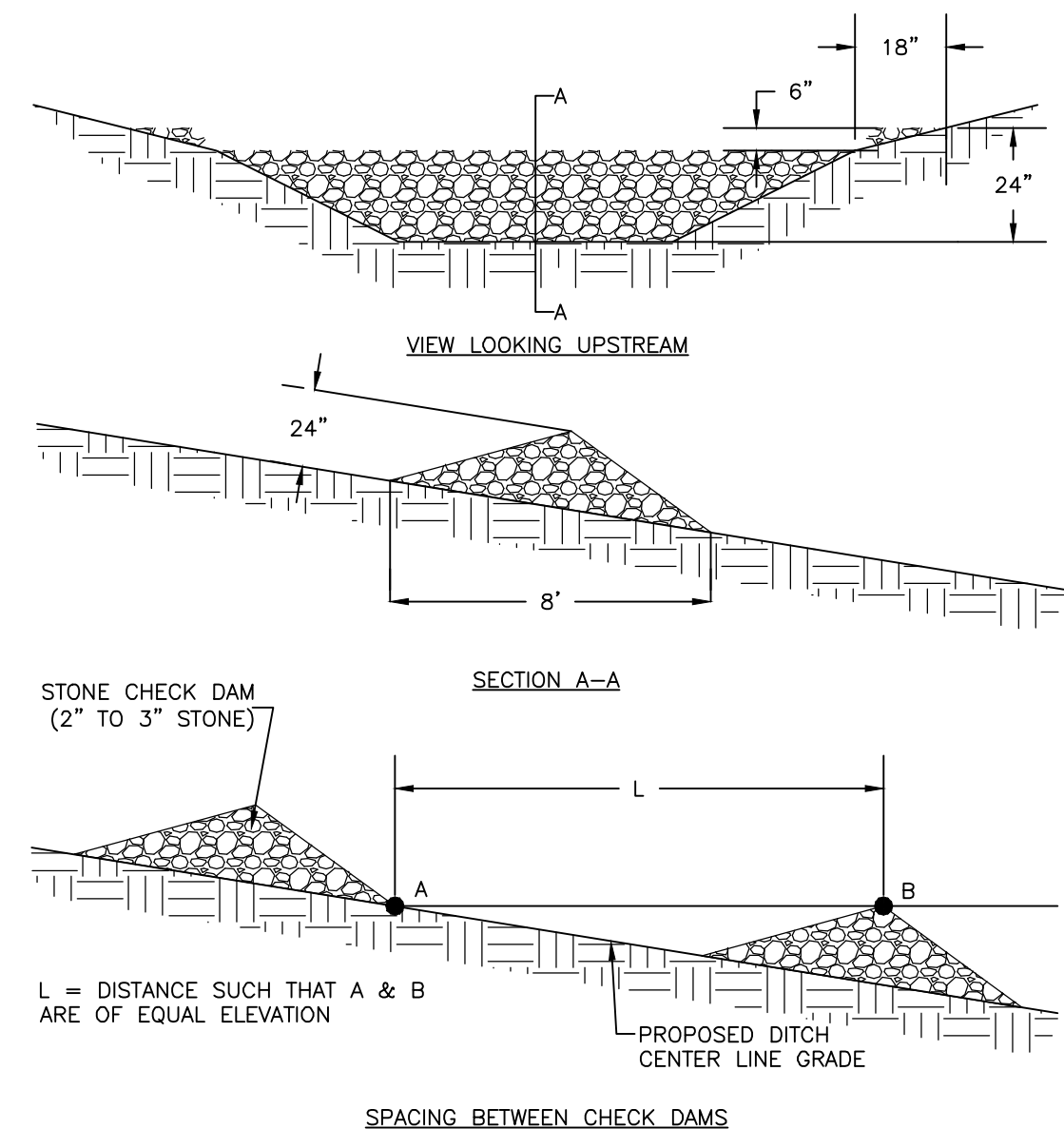
8
D-1

CONSTRUCTION DETAILS

LISA KAVENEY
TAX MAP 6 LOT 30
82 BABOOSIC LAKE ROAD
AMHERST, NEW HAMPSHIRE

JUNE 3, 2024

SCALE: AS NOTED

D-1

SHEET

FILE: 12277P00.dwg

PROJECT 12277.00

SHEET NO. 2 OF 2